



Prospect Place , Maidstone ME16 8EG

- Attractive Top Floor Studio
 - Share of Freehold
- Three Piece Shower Room
- Ideal First Home or Investment Opportunity
- Quiet Cul De Sac Location
 - Separate Kitchen
 - Electric Heating
 - Offered Chain Free

Offers In The Region Of £125,000 Leasehold - Share of

Local Authority Maidstone
Borough Council
Council Tax Band A
EPC Rating E



Denotes restricted
head height

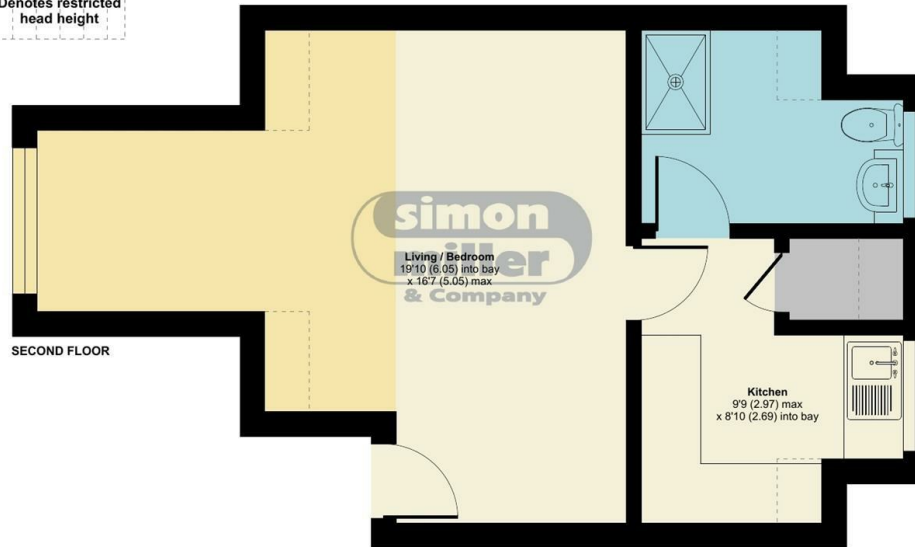

Prospect Place, Maidstone, Kent, ME16

Approximate Area = 353 sq ft / 33 sq m
Limited Use Area(s) = 21 sq ft / 2 sq m
Total = 374 sq ft / 35 sq m
For identification only - Not to scale



Floor plan produced in accordance with RICS Property Measurement Standards incorporating International Property Measurement Standards (IPMS2 Residential). © nichecom 2023. Produced for Simon Miller & Company. REF: 934009

Maidstone & The Weald Office
11 Colman House, Colman Parade, King
Street, Maidstone, Kent, ME14 1DN

Contact
01622 691255
maidstonesales@simonmiller.co.uk

Agents Note: Whilst every care has been taken to prepare these particulars, they are for guidance purposes only. All measurements are approximate and for general guidance purposes only and whilst every care has been taken to ensure accuracy, they should not be relied upon and potential buyers/tenants are advised to recheck the measurements.